

Installation Instructions

LT45

Multi-Purpose Basket

BEFORE YOU BEGIN INSTALLING:

1. Read and understand these instructions completely.
2. Verify that you have received all the parts listed in the bill of materials for your model number.

Note: The multi-purpose basket comes in two boxes.

Tools Required:

- (2) 9/16" Wrenches and/or Sockets
- Electric Drill
- (1) 3/8" Drill Bit
- Tape Measure



Always wear safety glasses when using power tools.



Check for locations of brake lines and electrical wiring etc., before drilling any holes. Any damage to trailer during installation is installer's full responsibility.

INSTALLATION

1. Building the Basket (Fig 1, 2 and 3)

- a. Attach the Side Panels to the Bottom Panel using the 3/8"-16 Carriage Bolts and Flange Nuts.
- b. Attach the Front and Rear Panels to the Side Panels using 3/8"-16 Carriage Bolts and Flange Nuts.
- c. Insert the Dividers to desired locations and loosely attach with 3/8"-16 Hex Head Cap Screws (HHCS) and Nylon Locking Nuts.

Note: Dividers can be set in different locations along the inside of the basket. Use the side bolt pattern to customize your basket to fit your specific needs.



Fig. 1

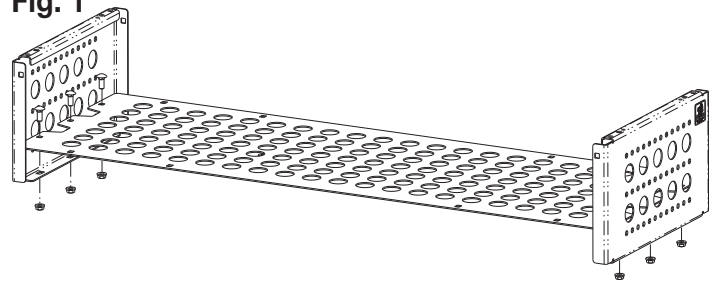

Fig. 2

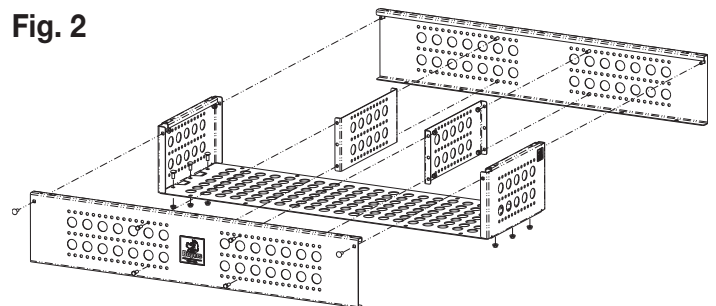
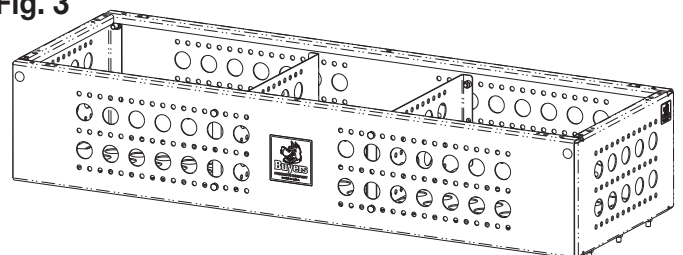

Fig. 3



2. Legs (Fig 4)

- a. Unfold the preassembled Legs and secure in place with a 3/8"-16" HHCS and Nylon Locking Nut.

Fig. 4

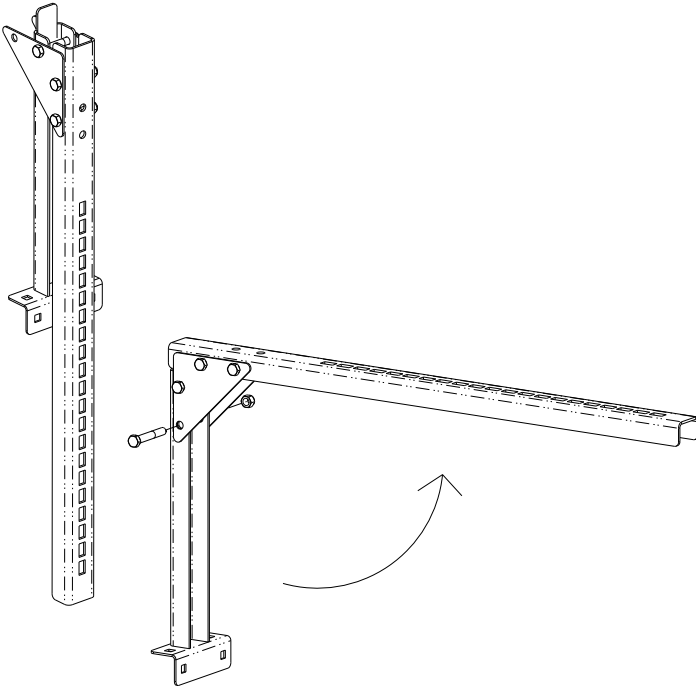

3. Installing Legs and Mounting onto Trailer (Fig 5, 6 and 7)

- a. Measure the inside width of Trailer rails at the location you will be mounting the Basket.
- b. Use Figure 5 as a starting point reference in determining which slot positions will be used. **Notes: The position numbers referenced are for the inner bolts. The outer bolts will line up with a slot once the inner bolts are installed. The Basket must be installed so it is centered on the trailer.**
- c. Use 3/8"-16 Carriage Bolts and Flange Nuts to attach the Legs to the bottom of the Basket.
- d. Remount the Basket onto the trailer in its desired location and tighten all bolts.
- e. Use the holes in the Legs to mark the mounting location on the trailer rails. Remove the Basket, drill mounting holes, reposition the Basket and fasten in place. **Note: Provided hardware is designed for a 3/8" thick angle rail. Tubular rails will require different hardware which may be purchased from a hardware store.**

Fig. 5

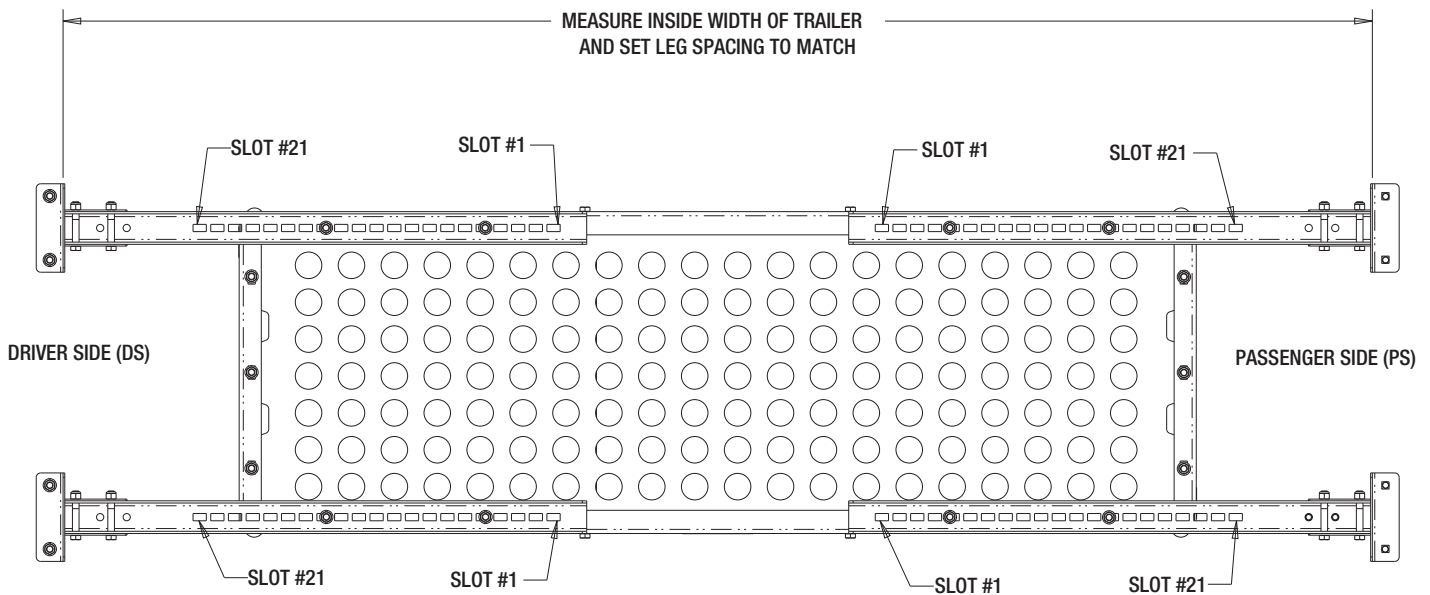

SUGGESTED SLOT POSITIONS FOR STANDARD WIDTH TRAILERS

- 5 FT WIDE USE SLOT POSITIONS #11 - DS / #12 - PS
- 5-1/2 FT WIDE USE SLOT POSITIONS #8 - DS / #9 - PS
- 6 FT WIDE USE SLOT POSITIONS #5 - DS / #6 - PS
- 6-1/2 FT WIDE USE SLOT POSITION #3 ON BOTH SIDES

Fig. 6

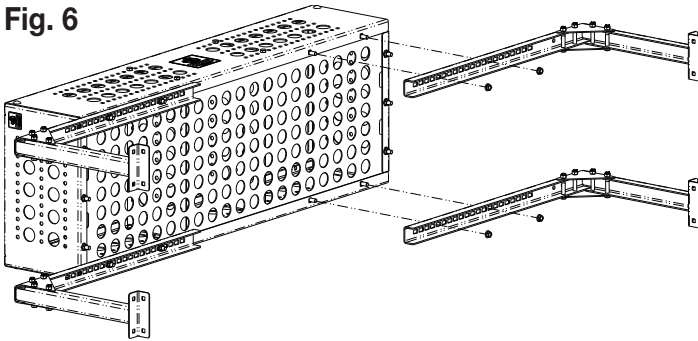
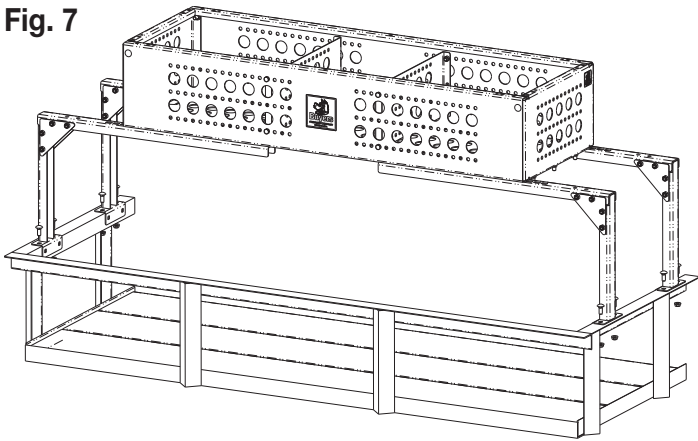

Fig. 7



4. Blower Holder and Trimmer Line Spool Bracket (Fig 8)

- a.** Follow the product instructions for the Blower Holder and/or Trimmer Line Spool Bracket if you choose to install them.
- b.** The Blower Holder may be drilled and installed on any side of the Basket while there are predrilled holes on the Legs and top of the Basket to be used for the Trimmer Line Spool Bracket

Fig. 8

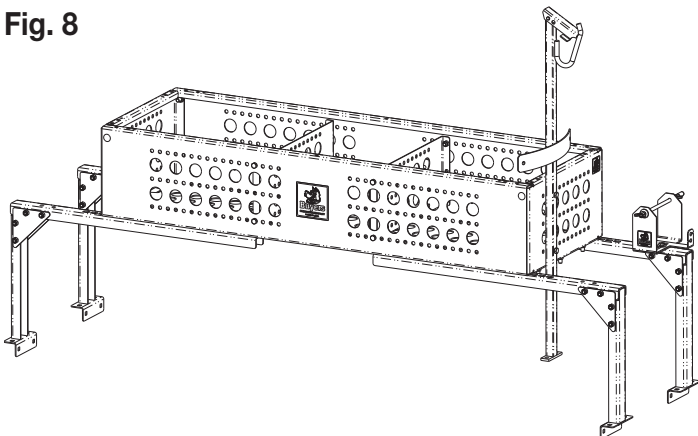

Warranty

Buyers Products Co. warrants all truck/trailer hardware manufactured or distributed by it, to be free from defects in material and workmanship for a period of one year from date of shipment. Parts must be properly installed and used under normal conditions. Any product which has been altered, including modification, misuse, accident or lack of maintenance will not be considered under warranty. Normal wear is excluded. The sole responsibility of Buyers Products Co. under this warranty is limited to repairing or replacing any part or parts which are returned, prepaid, and are found to be defective by Buyers Products Co. Authorization from Buyers Products Co. must be obtained before returning any part. No charges for transportation or labor performed on Buyers' products will be allowed under this warranty.

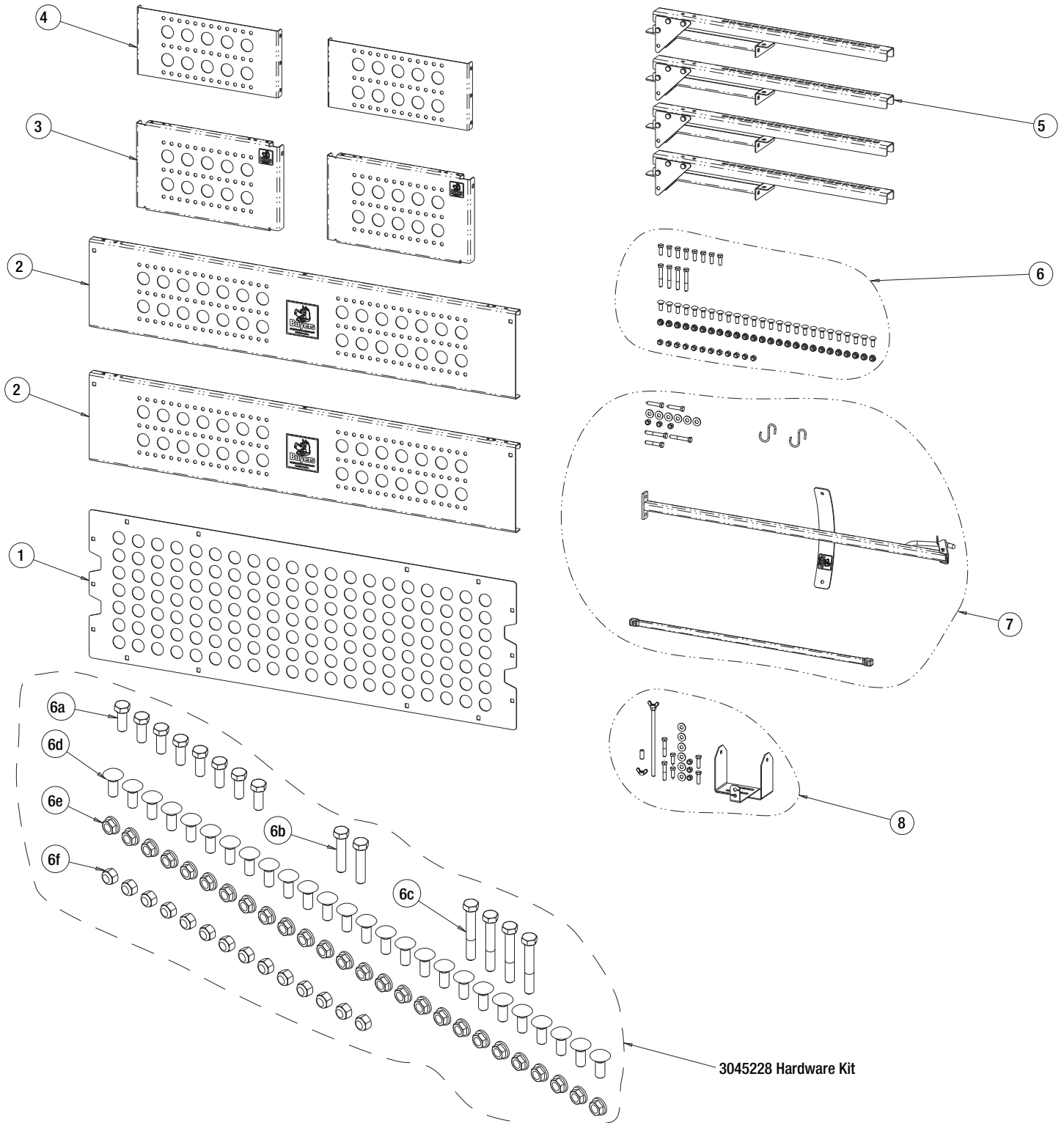

Bill of Materials

ITEM	PART NO.	QTY.	DESCRIPTION
1	3045212	1	PANEL,BOTTOM
2	3045213	2	PANEL,MAIN
3	3045214	2	PANEL,SIDE
4	3045217	2	PANEL,DIVIDER
5	3045232	4	LEG,ASSEMBLY
6	3045228	1	HARDWARE KIT
7	LT20	1	RACK,BACKPACK BLOWER
8	LT40	1	BRACKET,TRIMMER LINE SPOOL

Hardware Kit - 3045228

ITEM	PART NO.	QTY.	DESCRIPTION
6a	FCS038016100	8	SCREW,HHCS, 3/8"-16 X 1
6b	FCS038016175	2	SCREW,HHCS, 3/8"-16 X 1.75
6c	FCS038016250	4	SCREW,HHCS, 3/8"-16 X 2.5
6d	FCB037516100	26	BOLT,CARRIAGE, 3/8"-16 X 1
6e	92401211	26	NUT,SERRATED FLANGE, 3/8"-16
6f	FNE038016044	16	NUT,NYLON LOCKING, 3/8"-16